



**WARNING: To avoid serious personal injury:**

- Carefully and strictly follow assembly instructions. Improper assembly of furniture can result in structural failure, instability of the product, or tip-over.
- Monitor and carefully control the assembly components. These include small parts and hardware that may present a choking hazard to small children. Bob's furniture should be assembled only by responsible adults and children should not be involved in the assembly process.
- Where provided, wall mounting hardware should always be used as prescribed in these instructions to anchor furniture to walls. Proper use of the wall mounting hardware can significantly reduce the potential for furniture tip-over and crushing injuries.

# Included in the package

01 - Base = 01 piece

02 - Left side panel = 01 piece

03 - Right side panel = 01 piece

04 - Top panel = 01 piece

05 - Back panel = 01 piece

06 - Front of the drawer = 01 piece

07 - Left side panel of the drawer = 01 piece

08 - Right side panel of the drawer = 01 piece

09 - Rear panel of the drawer = 01 piece

10 - Base of the drawer = 01 piece

11 - Decorative apply = 01 piece

12 - Feet = 04 pieces

13 - Shelf = 01 piece

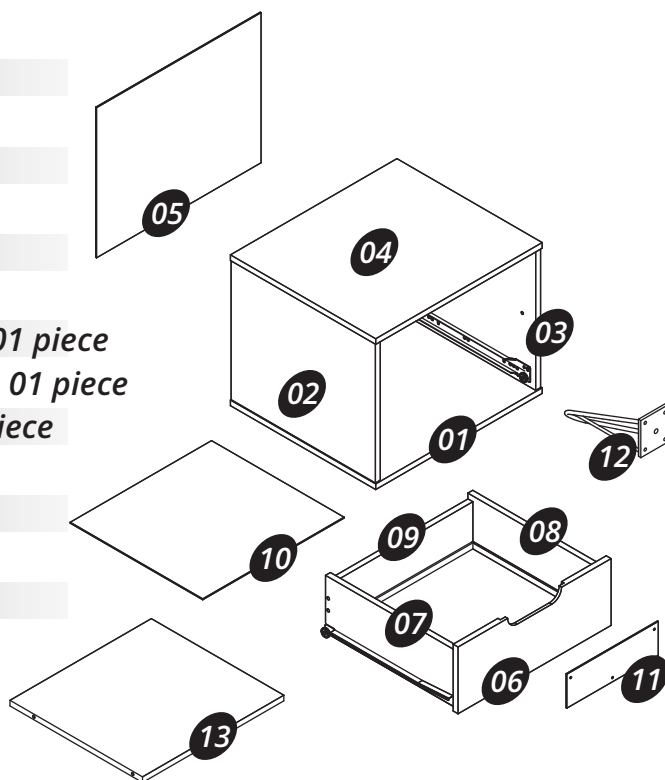

A = 16x

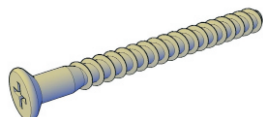

B = 08x

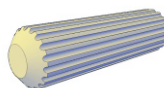

C = 08x

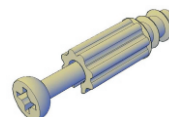

D = 12x



E = 12x



F = 03x

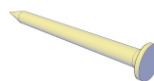

G = 20x



H = 12x

**Tools needed  
(not included)**



⌘ Phillips screw driver

⌘ Screw driver

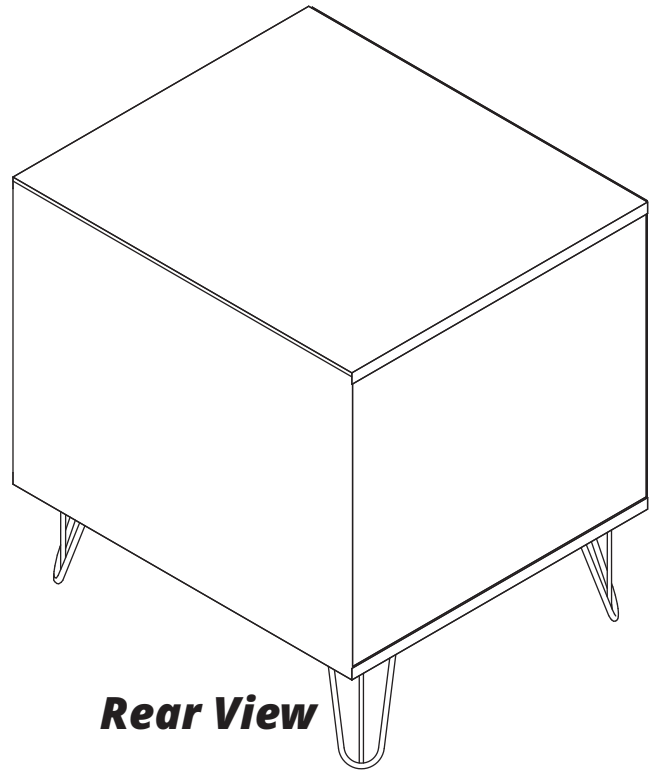
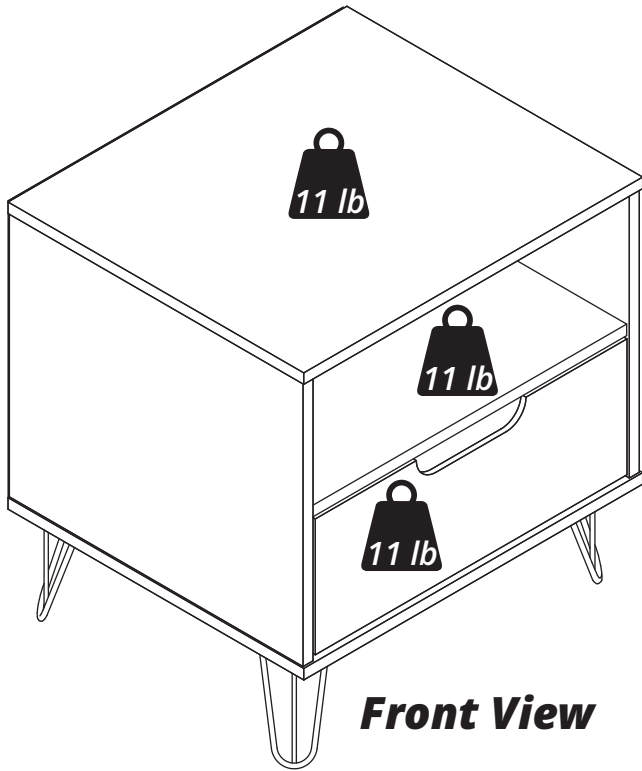

**Step 01**

*Fix the parts (12) under the part (01) with the hardware (A).*

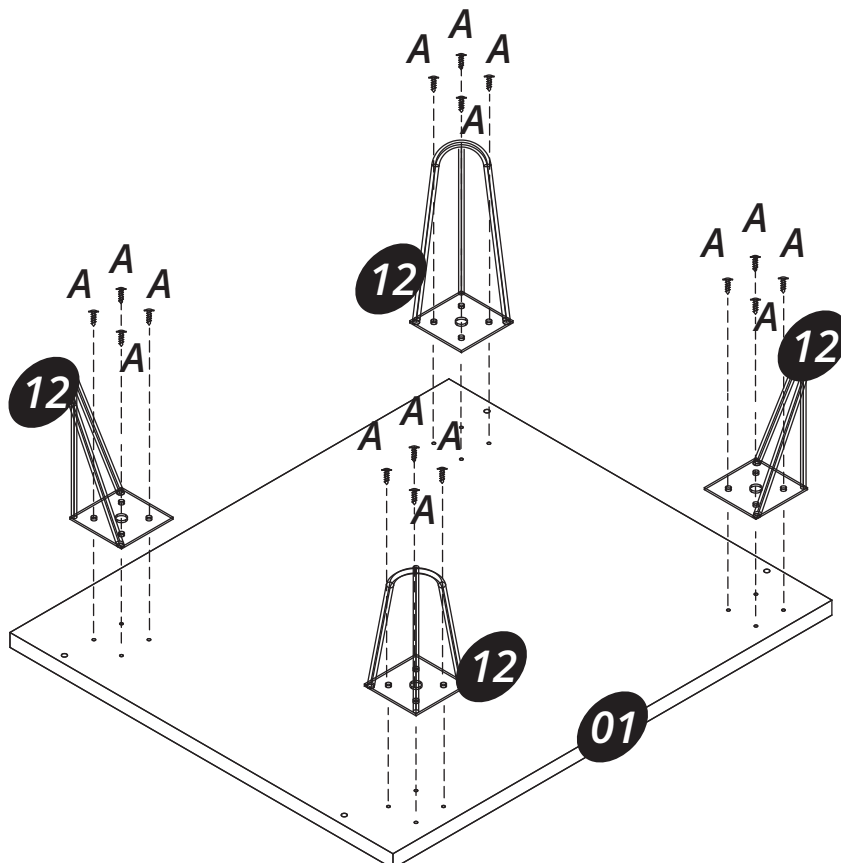

## Step 02

Connect the part (13) onto the parts (02) and (03) with the hardware (D + E).

Apply the hardware (H) on the hardware (E).

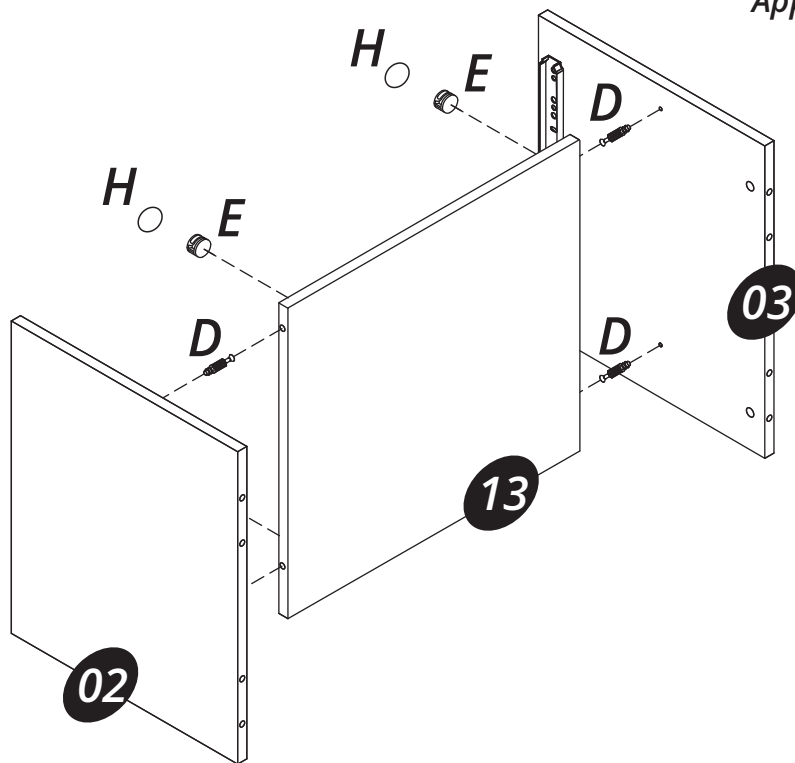

## Step 03

Connect the parts (02) and (03) onto the part (01) with the hardware (C) and (B).

Connect the part (04) onto the parts (02) and (03) using the hardware (C) and the hardware (D + E).

Apply the hardware (H) on the hardware (E).

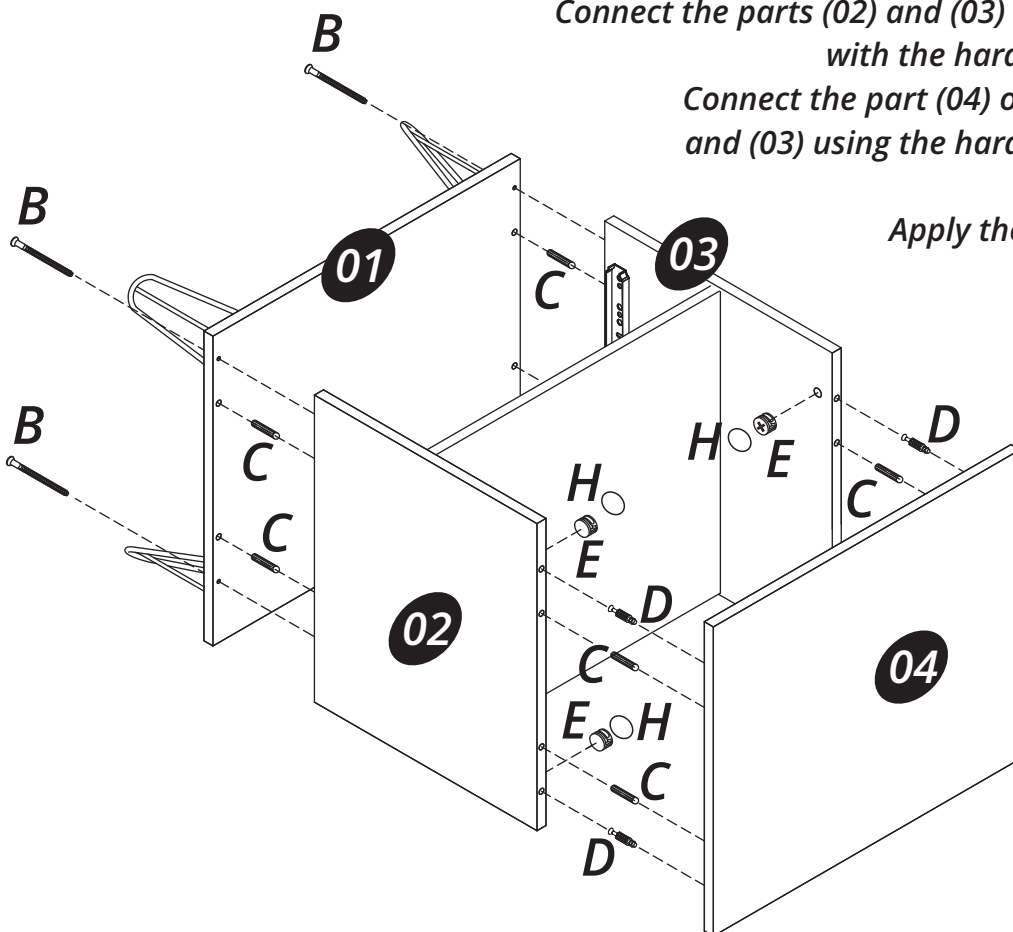

#### Step 04

Connect the part (05)  
with the hardware (G).

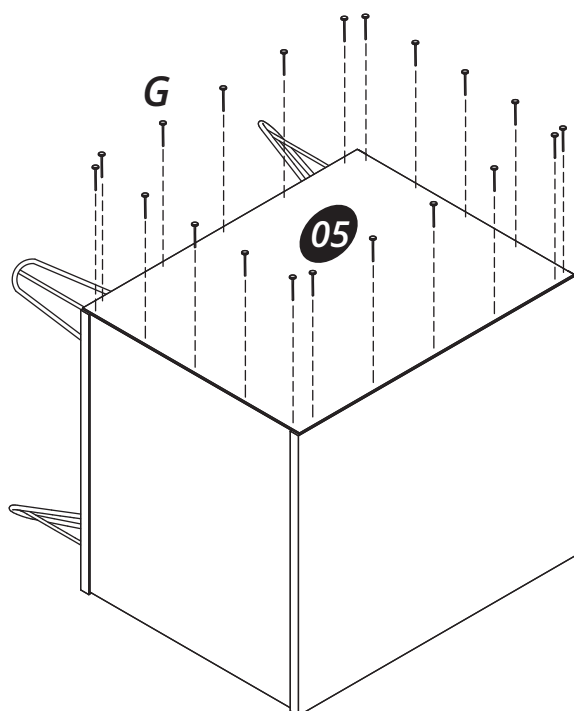

#### Step 05

Connect the part (11) onto  
the part (06) with  
the hardware (F).

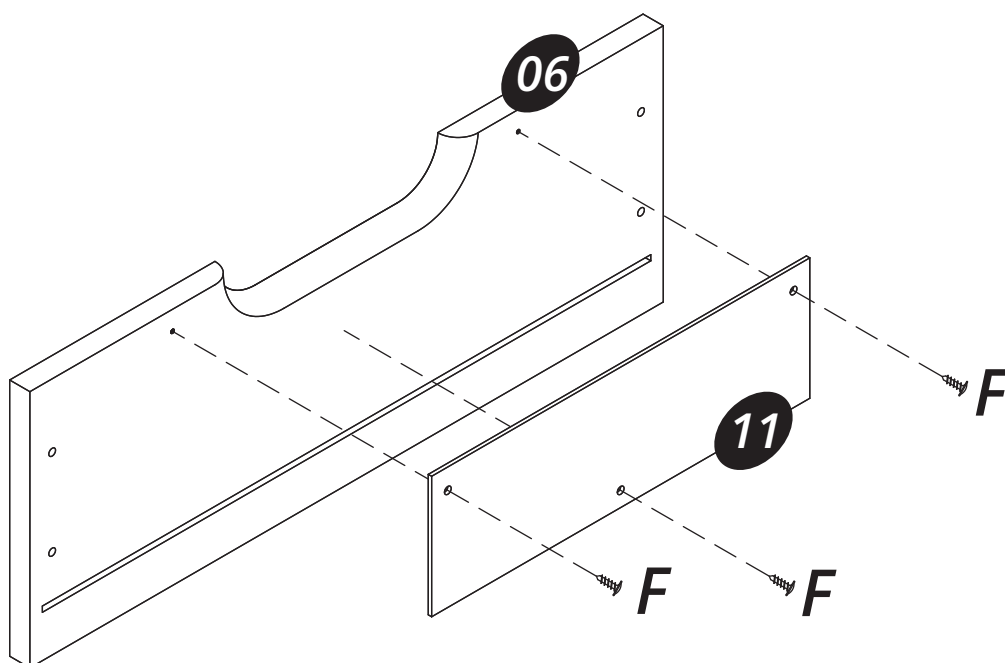

### Step 06

Connect the parts (07), (08) and (09) with the hardware (B).  
Apply the part (10) in the groove of the  
parts (07) and (08) until the groove  
of the part (09).

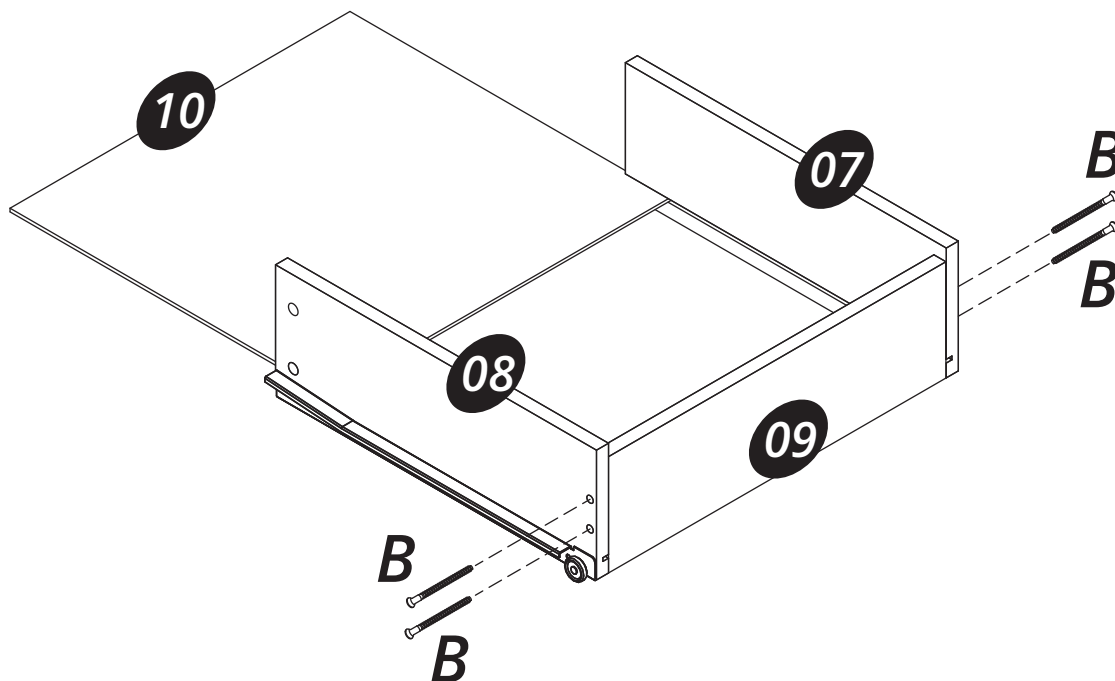

### Step 07

Connect the parts (07), (08) and (06)  
using the hardware (D + E).  
Apply the hardware (H)  
on the hardware (E).

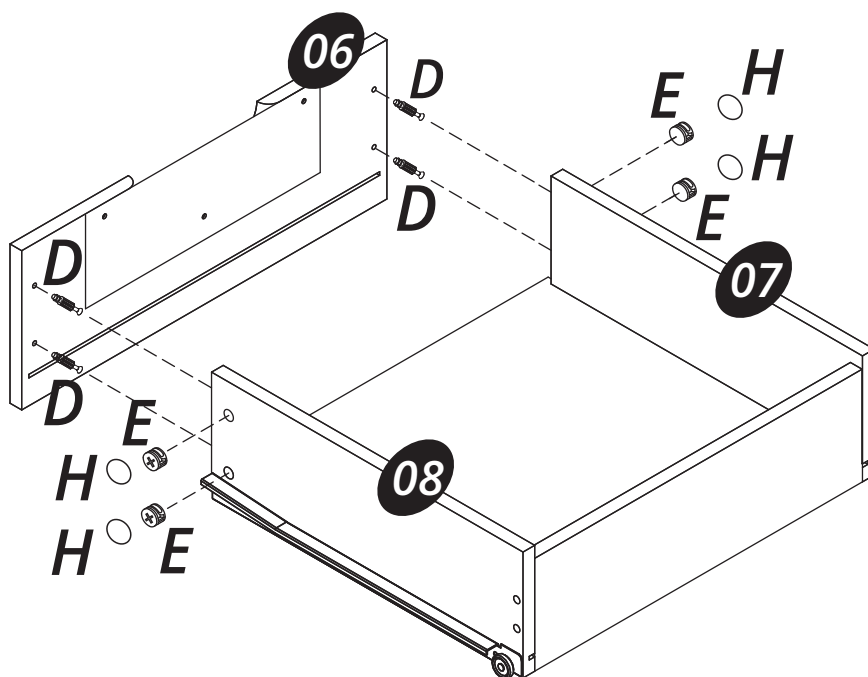

**Step 08**

*Install the drawer fitting it into  
the slides fixed on the side  
of parts (02) and (03).*

